



Urbanes Wohnen und Gewerbe

Turmstraße 43
Neu-Ulm, Deutschland

Träger Architekten

Bauherrschaft

Panescu & Stubner GbR

Planung

2011 - 2017

Grundstücksfläche

18.400 m²

Urbanes Wohnen und Gewerbe

Sanierung, Umbau und Baurechtsentwicklung einer gewerblich genutzten ehemaligen Sanitätskaserne, Teil der Befestigungsanlagen Neu-Ulms aus dem 19. Jahrhundert

Fassadensanierung, Baurechtsentwicklung



KRIEGSSPITAL N°5.
Grundriss des 1^{ten} Geschosses 1:11.337.1

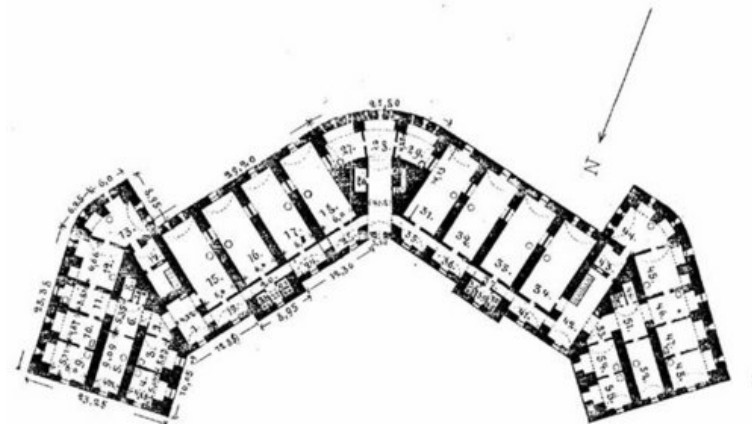

© Tröger Architekten München

Urbanes Wohnen und Gewerbe

Panescu&Stubner_Kriegsspital Neu-Ulm_Grundriss

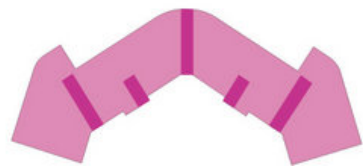
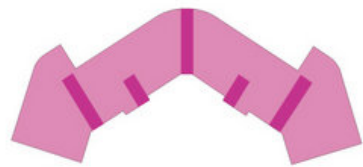

© Tröger Architekten München

Panescu&Stubner_Kriegsspital Neu-Ulm_Analyse

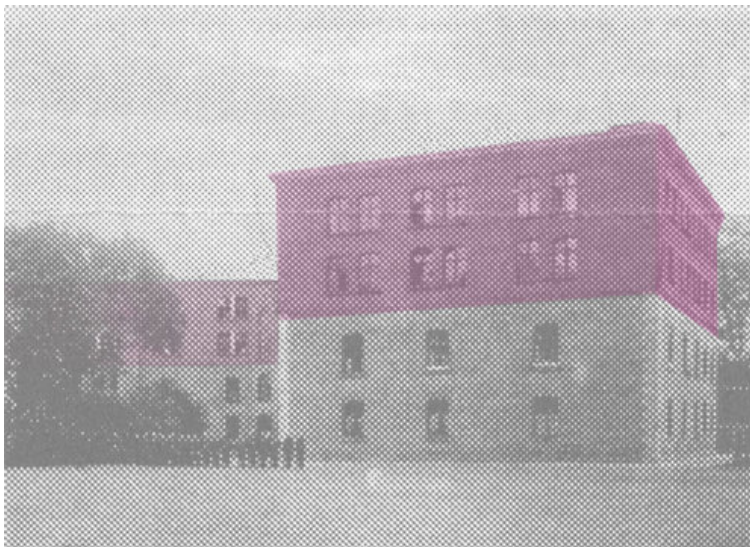

© Tröger Architekten München

Panescu&Stubner_Kriegsspital Neu-Ulm_Fassade

Urbanes Wohnen und Gewerbe

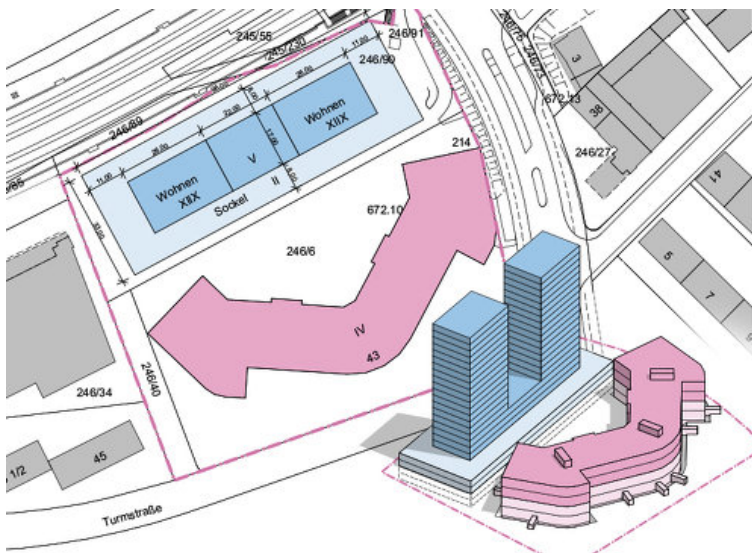
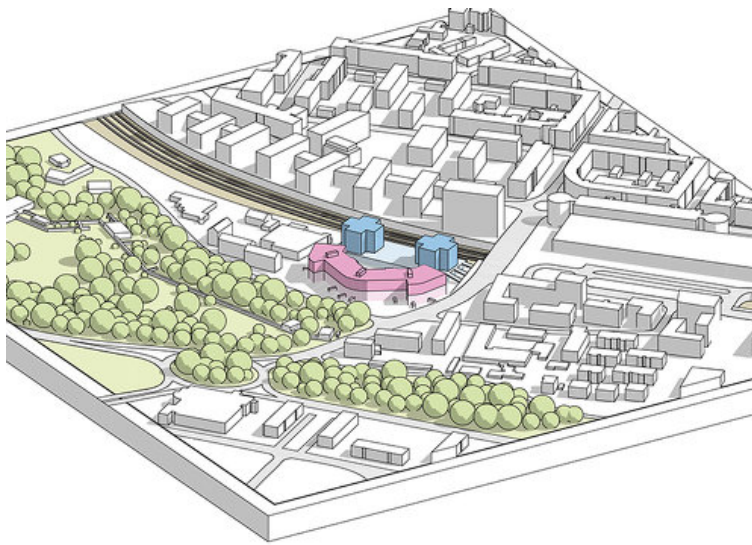
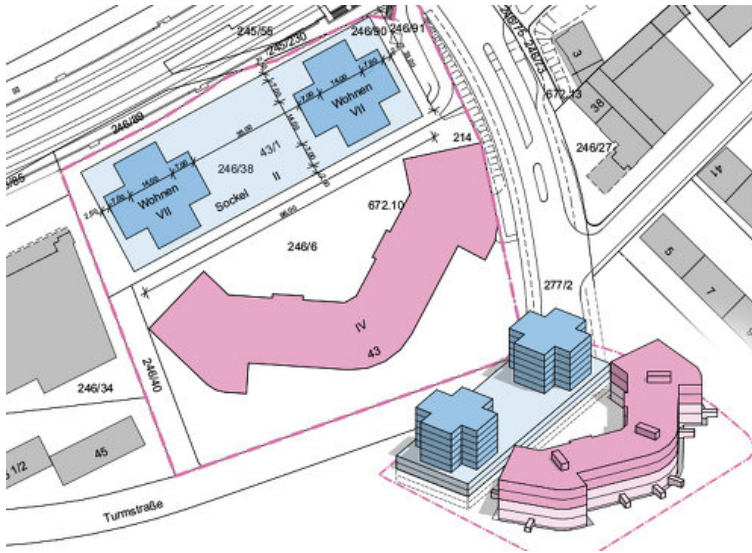

Urbanes Wohnen und Gewerbe

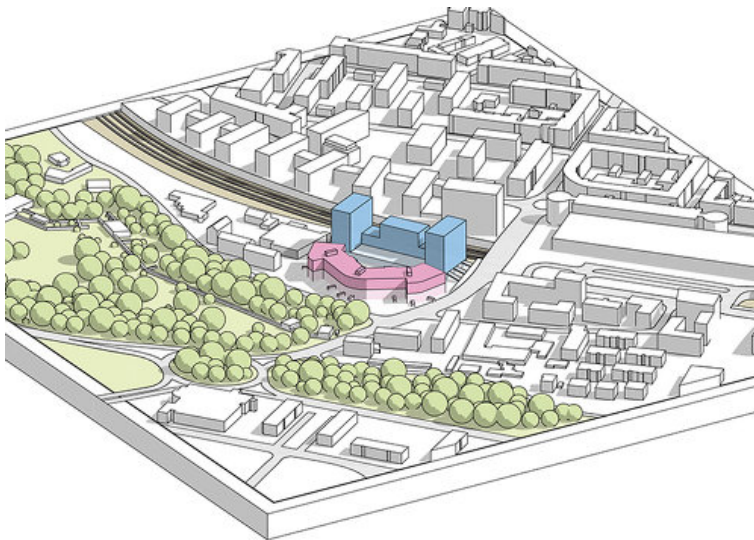
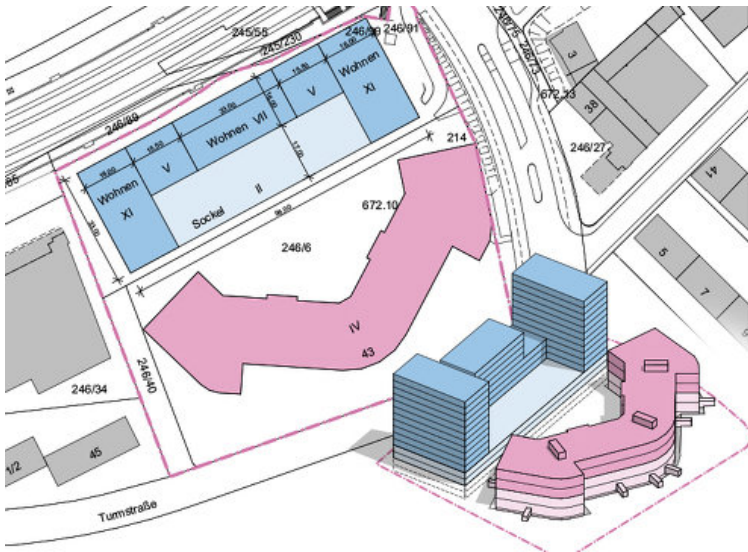
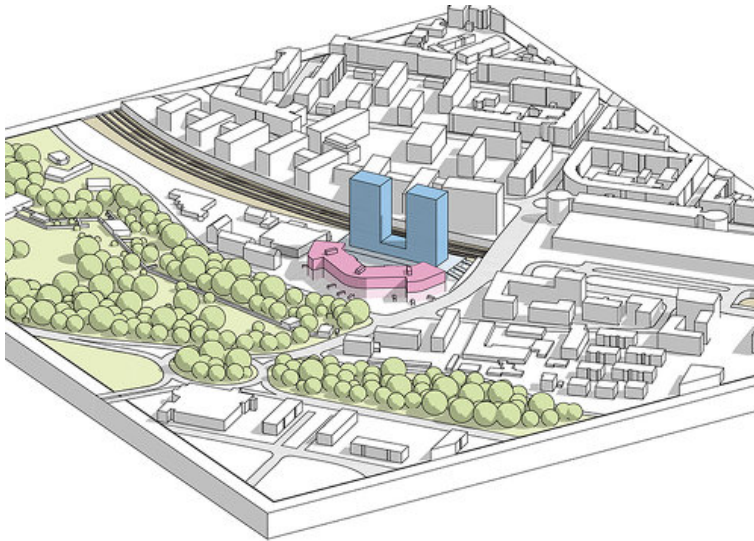

Urbanes Wohnen und Gewerbe

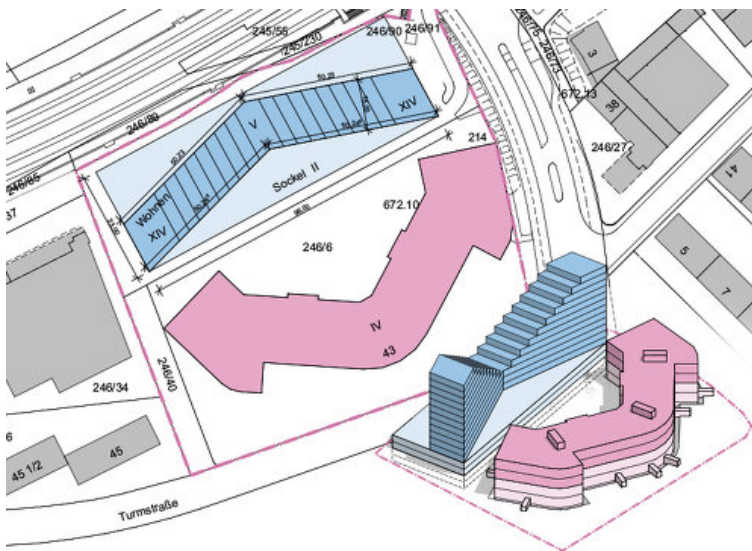
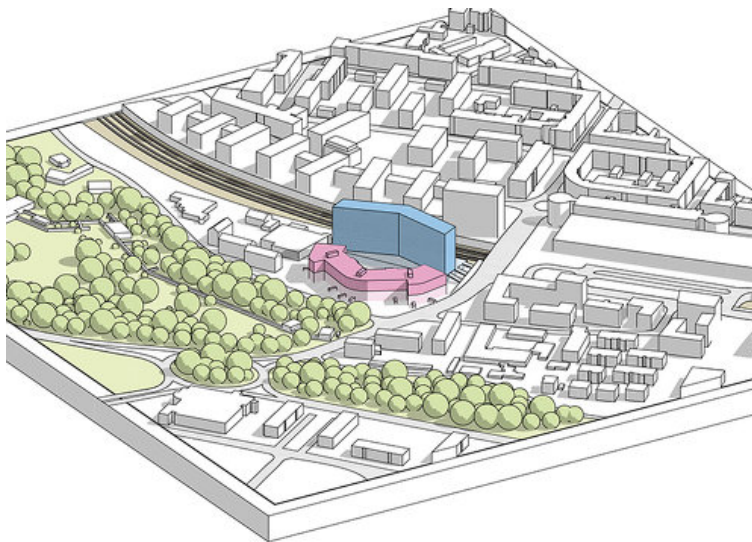
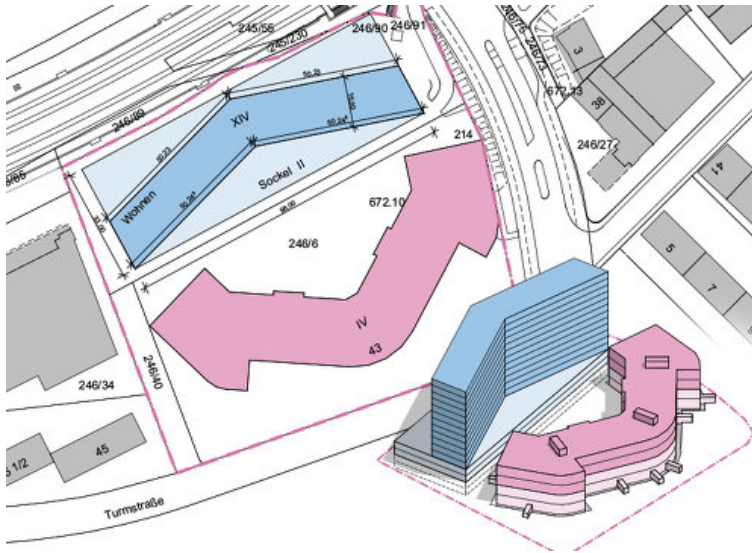

Urbanes Wohnen und Gewerbe

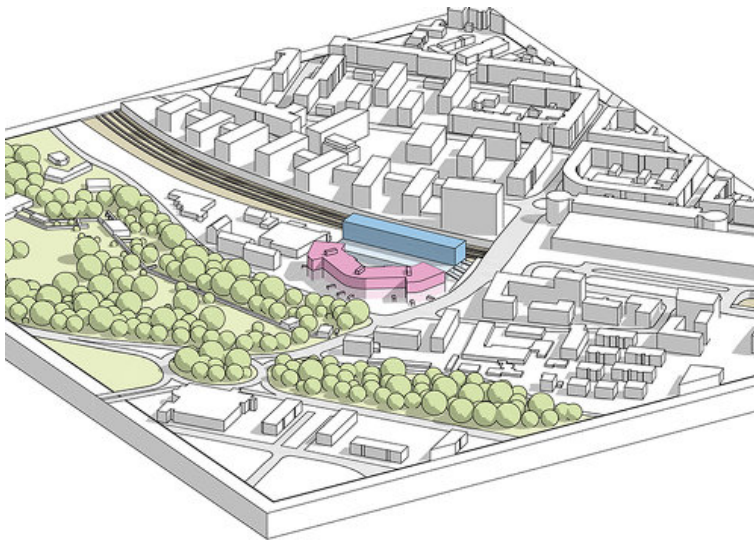
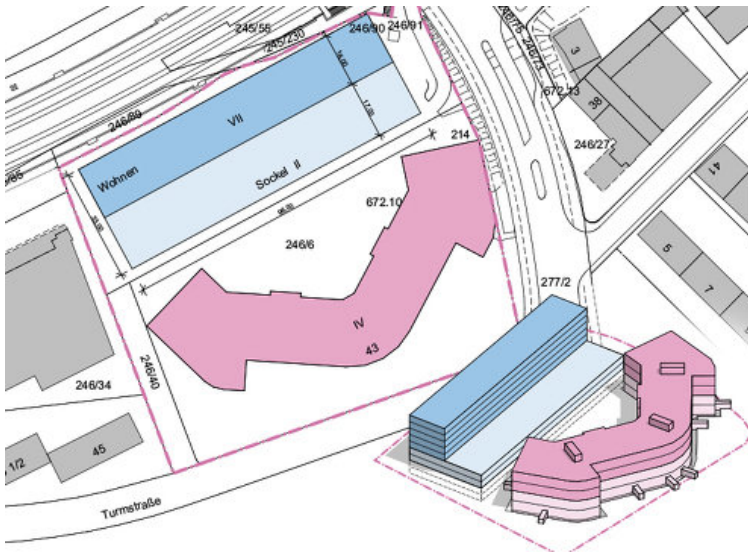
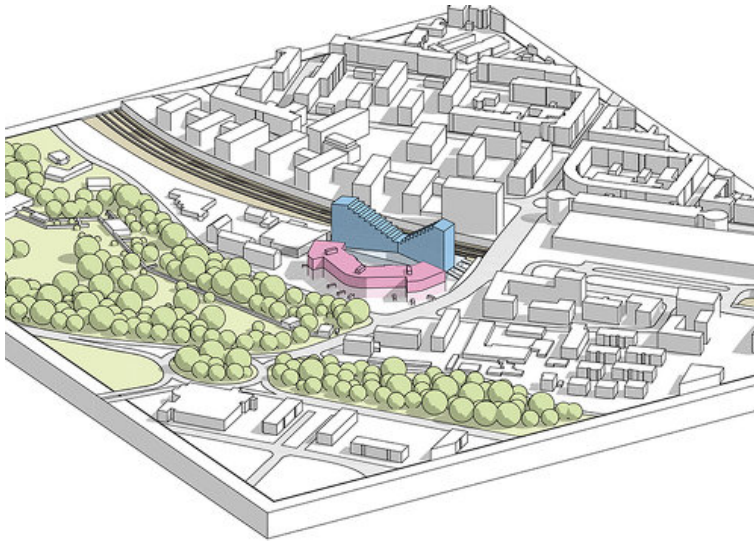

Urbanes Wohnen und Gewerbe

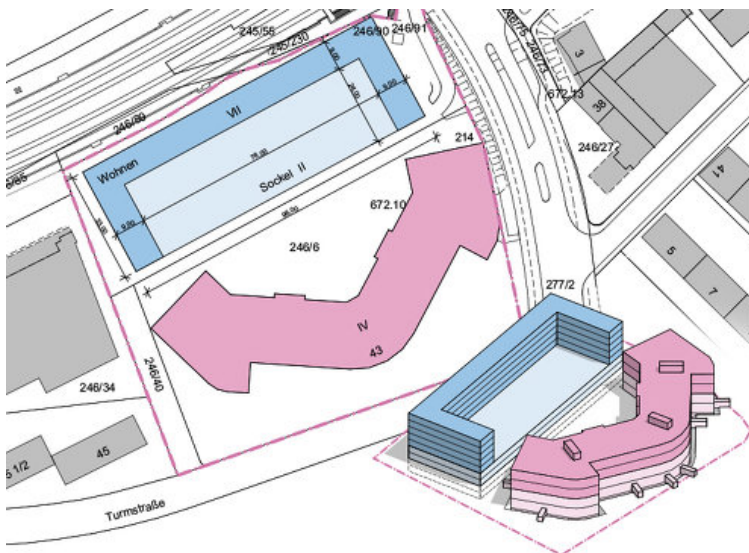
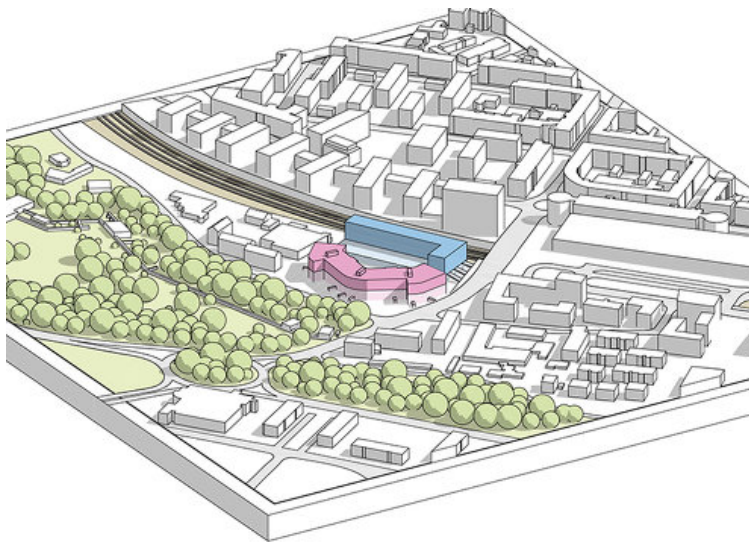
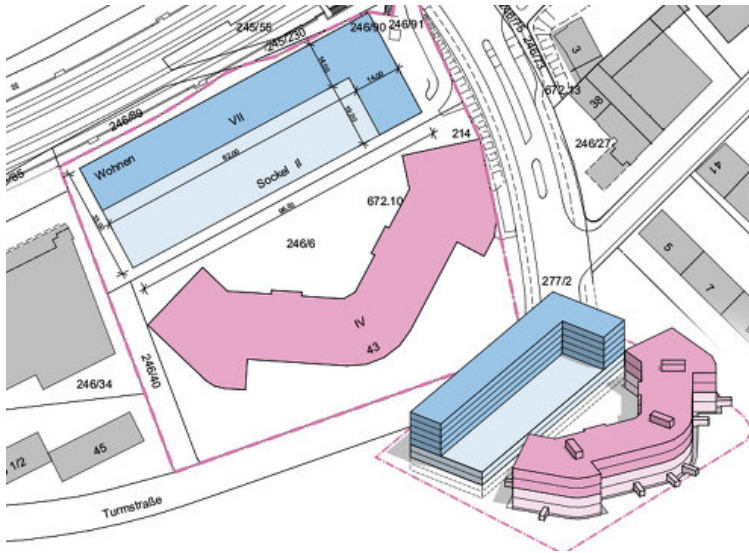

Urbanes Wohnen und Gewerbe

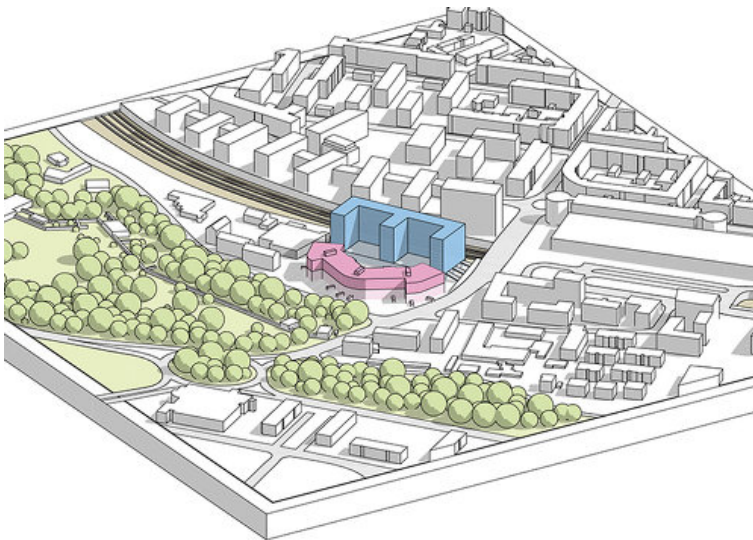
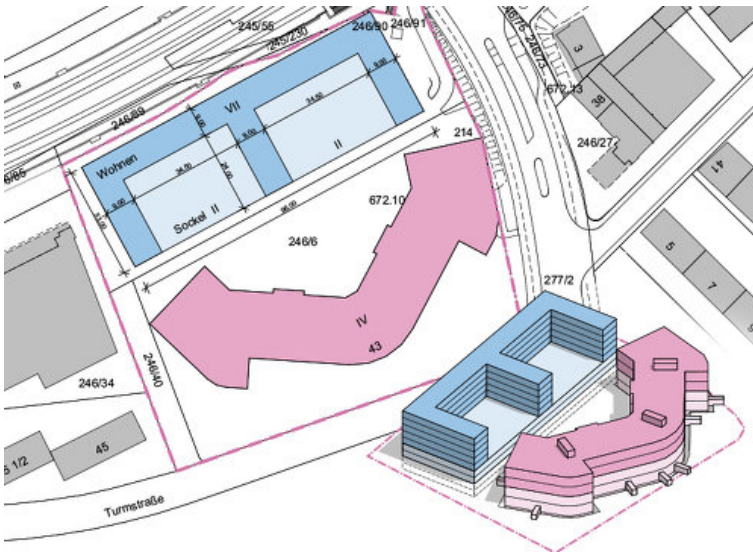
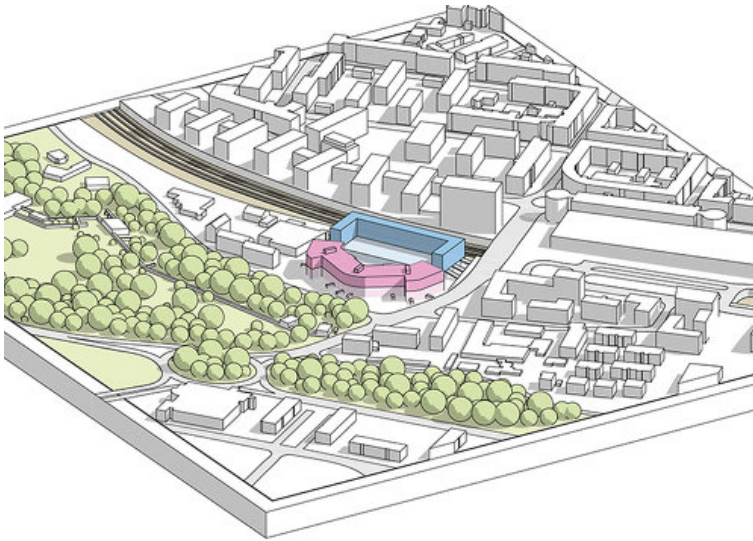

Urbanes Wohnen und Gewerbe

